

# How to sew on a button



FAST  
FIXES

10

## YOU WILL NEED

- ✓ A button that matches the other buttons on the garment
- ✓ Matching thread
- ✓ A hand sewing needle
- ✓ Scissors

## DIFFICULTY

EASY

## METHOD

1

Source a button which matches the existing buttons – you might find it sewn on to the care label on the inside of the garment or you may have to buy a new one from a haberdasher.

2

Find the exact spot that the button needs to be placed on the garment and mark it with a pin.

3

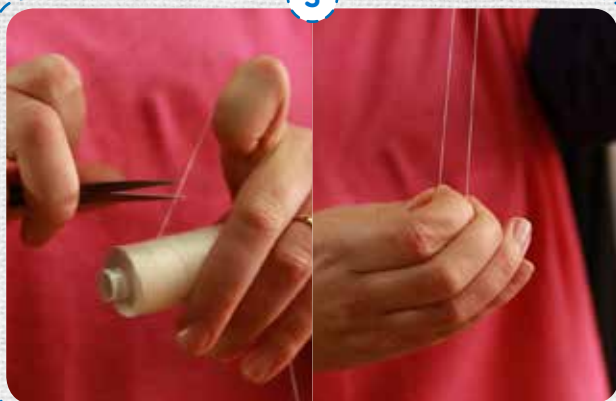

Choose a thread which matches the garment and thread your needle using a double thread. Tie a knot in the end of the thread and snip off the excess beneath the knot.

4

On the right side of the garment (as it will be hidden by the button) remove the pin and put your needle in and out of the fabric and back through the doubled thread just before the knot pulls tight, this will secure your thread.

5



Making sure the button is the right way up, put the needle up through the first hole and then back down through the next hole and back into the garment, pull it so the button is flat against the fabric and make sure it is still in the central position.

- For a button that has 4 holes, ensure you match the way that the other buttons have been sewn on (stitch through the holes either using a + or a x pattern). Either way is just as strong.



SUPPORTER LOGO  
TO GO HERE

PROUD TO SUPPORT



YOUR CLOTHES

[www.loveyourclothes.org.uk](http://www.loveyourclothes.org.uk)







- For a button with a shank attached, you will sew through the shank from one side to the other and then back down through the fabric.



6

Sew back up through the fabric and through the buttonhole, repeat this process until you feel that the button is secure – don't do it so many times that your button looks overloaded with thread!

7

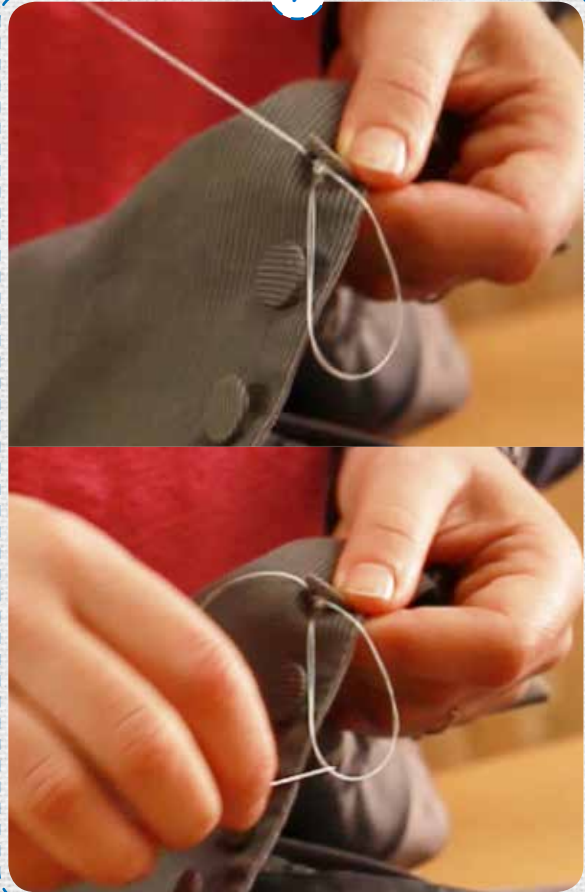

On the last stitch, take the needle down through the buttonhole but without going through the fabric, then wrap the thread securely around the threads between fabric and button several times to strengthen and to bring all the thread together.

8

Tie off the thread and snip off the loose ends.

Visit [www.loveyourclothes.org.uk](http://www.loveyourclothes.org.uk) to watch our 'How to sew on a button' film.

